

APPENDIX G
SURVEYOR'S REPORT

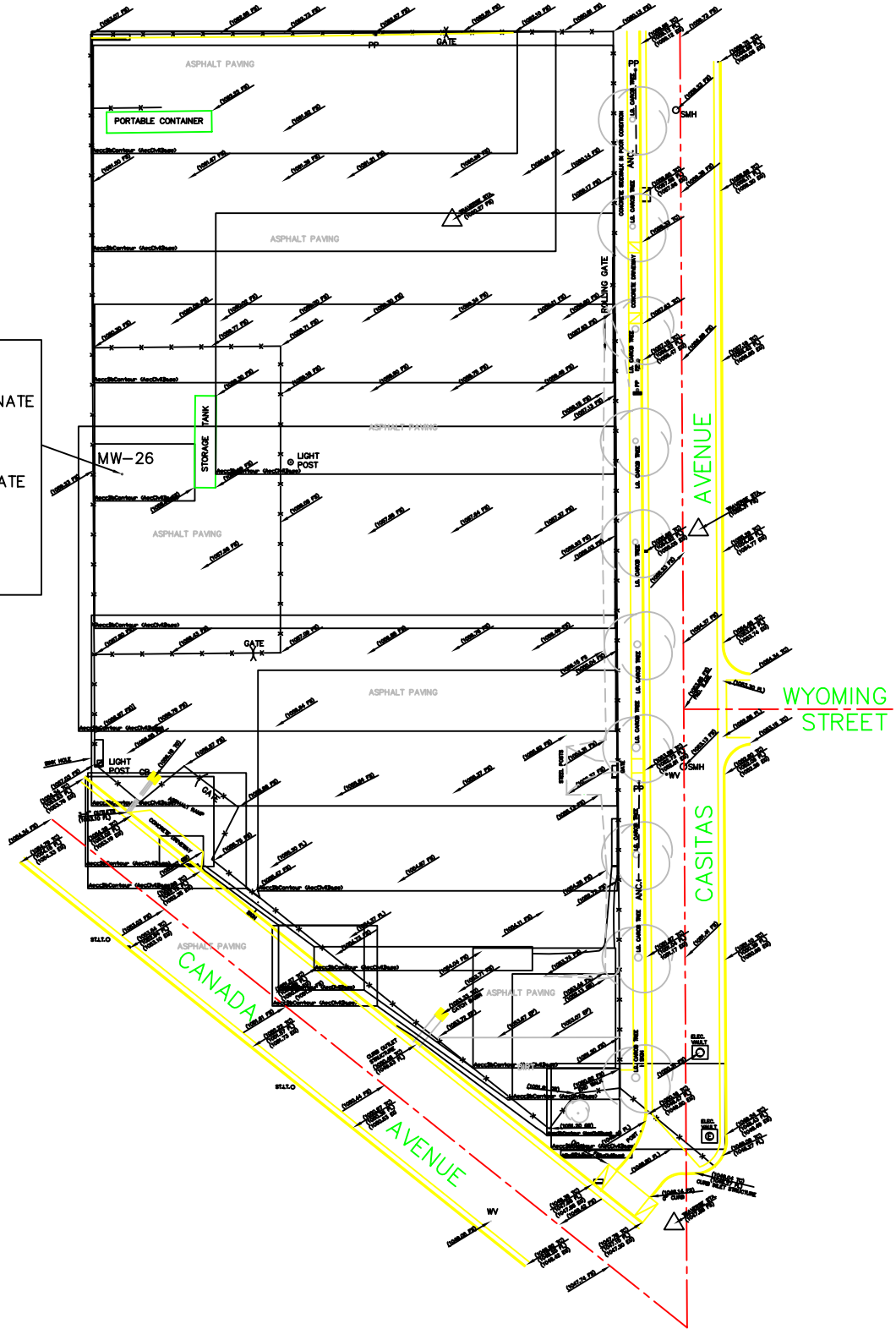

SCALE: 1" = 20'

MONITOR WELL # 26
 CALIFORNIA ZONE 5
 STATE PLANE COORDINATE
 NAD 83
 N 1887624.430
 E 6511824.030
 GEOGRAPHIC COORDINATE
 NAD 83
 LAT: 34° 10' 44.99"
 LON: 118° 09' 53.26"
 ELEVATION = 1059.08'
 (U.S. FEET)



NOTE: STREET CENTERLINES SHOWN BASED ON FOUND MONUMENTATION OR SPLIT OF STREET IMPROVEMENTS AND SHOULD BE CONFIRMED BEFORE USE FOR CONSTRUCTION PURPOSES.

<p>BASIS OF BEARINGS: CONTROL BASED ON STATE PLANE COORDINATE CONTROL BY CORRECTION TO THE NAD 83 DATUM. BASE OF BEARINGS: MONROVIA, CALIF.</p>	<p>BENCHMARK: LOS ANGELES CO. BENCHMARK NO. Y 7709 BASELINE (1940) ADA. POINT TAD 11 OR 600MM N/O BOX @ NW COR LINCOLN AVE. & MONROVIA RD. 3.2 30" X 3" 60 9/10 C/A INT. ELEVATION = 1059.08' (U.S. FEET) ELEVATION = 335.364 (METERS)</p>	<p>LEGEND: THE FOLLOWING ABBREVIATIONS MAY APPEAR ON THIS MAP: TO = TOP OF CURB CB = CURB BREAK TO = TOP OF GUTTER PL = PAVEMENT SURFACE TO = TOP OF WALL RW = RIGHT OF WAY PS = POINT ON SLUPE ST = STAKE SURVEYOR DOWNSLO = SPOT ELEVATION PS = POINT SURVEYOR CB = CURB BREAK PL = PAVEMENT SURFACE TO = TOP OF GUTTER RW = RIGHT OF WAY PS = POINT ON SLUPE ST = STAKE SURVEYOR DOWNSLO = SPOT ELEVATION PS = POINT SURVEYOR</p>	<p>PROJECT SURVEYOR: EUGENE C. DUNHAM DATE: _____ ORIGINAL PLAN BEARS THE SET STAMP AND SIGNATURE OF THE PROJECT SURVEYOR. DIGITAL DATA IS SUBJECT TO CHANGE BY ORDERS AND SHOULD BE USED WITH CAUTION. (REVISED APPROVED BY BLANK, INC. AND SIGNED BY THE PROJECT SURVEYOR NOTED ABOVE.)</p>	<p>TOPOGRAPHIC SURVEY PROVIDED BY: WESTERN STATES SURVEYING, INC. 899 W. FOOTHILL BOULEVARD, SUITE 107 MONROVIA, CA. 91016 Phone: (626) 357-5144 Fax: (626) 357-4255</p>	<p>CITY OF PASADENA LIMITED TOPOGRAPHIC SURVEY OF JOHN MUIR HIGH SCHOOL IN THE CITY OF PASADENA, COUNTY OF LOS ANGELES, STATE OF CALIFORNIA, AS OF MAY 20TH, 2005. DESIGN: N/A CHECKED: JTK. DRAWN: QTA. SURVEY DATE: MAY 20, 2005 JOB NO. WSS 05040 SHEET 1 OF 1</p>
---	--	--	---	--	---